

USE VEKTEK AT200163 TO INSTALL

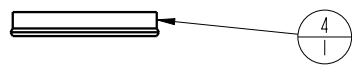

INSTALL WITH LIPS FACING BORE
USE VEKTEK AT200190 TO INSTALL

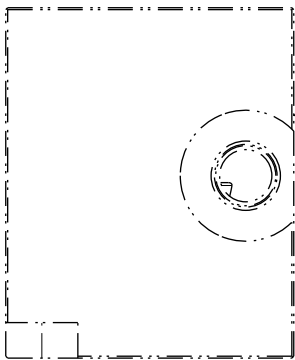

BODY NON-REPLACEMENT PART

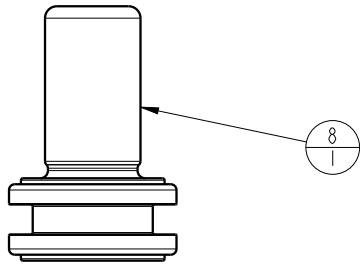
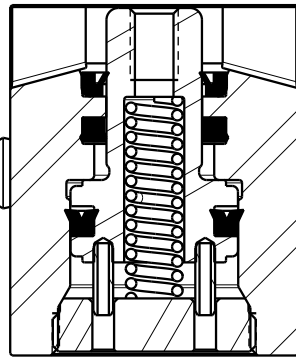

INSTALL WITH LIPS FACING PLUNGER THREADS

LUBRICATE ALL SEALS WITH CLEAN HYDRAULIC OIL PRIOR TO ASSEMBLY
DO NOT USE SILICONE BASED LUBRICANTS

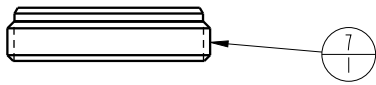
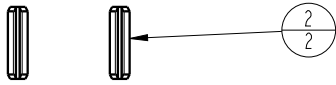
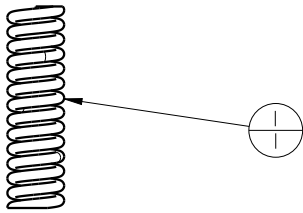
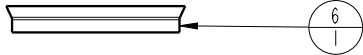

TORQUE TO 16FT-LB
USE VEKTEK AT200176 TO INSTALL

NO	QTY	PART NO	DESCRIPTION	STD SEAL KIT
1	1	23355012	SPRING, COMPRESSION	
2	2	23520008	PIN, SPRING, SLOTTED, 3/32 X 3/8, SST	
3	2	30601122	PLUG, SOCH, SAE 2	
4	1	39010019	SEAL, LL, (1/2 X 1/8 X 1/8 X 3/4)	X
5	1	39012009	WIPER, PRESS-IN, (1/2)	X
6	1	39052042	SEAL, U-CUP, 5/8 X 1/8 X 7/8	X
7	1	82040011	CAP, CYL, BB, PULL, 2000LB	
8	1	82140006	PLUNGER, CYL, CM, PULL, 2000LB	
N/A	N/A	60201118	KIT, SEAL, CYL, BB, PULL, 2000LB	NOTED

PARTS LIST



VEKTEK, INC.
1334 E. SIXTH AVE. P.O. BOX 625
EMPORIA, KS. 66801 U.S.A.

A	3539	RELEASE	MJUST	7/18/18
REV	IN ACCORDANCE WITH ECN	EFFECTIVE DATE	REVISED BY	DATE
DRW BY:	MJUST	DRAWING STATUS: Released		
DATE:	3/15/18	PRODUCTION APPROVED FOR RELEASED STATUS ONLY		

ASSEMBLIES AFFECTED
20-1109-01

PARTS LIST, ASSY, CYL, BB, PULL, 2000LB	
1/4-20 PLNGER THD	
SIZE A	PL2195
REV A	

FORM FEG035_PL_ASIZE, REV. B

SHEET 1 OF 1